

RoHS Compliant

ERON®

No.E-9405

Plain clamp

Material S45C

Heat Treatment HRC30 ± 5 heat treatment

Surface Treatment Blackened

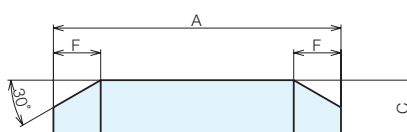
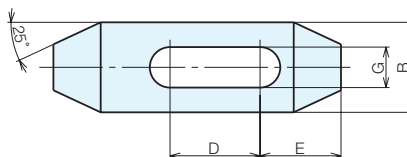
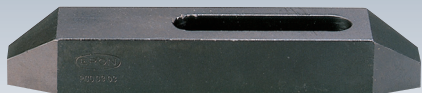

Specifications and Prices

(Price for 1 piece)

Order No.	No.	Compatible Bolts	A	B	C	D	E	F	G	Weight (kg)
901107	PC00101	M8	60	25	12	21	20	11	9	0.06
902032	PC00102	M8	100	25	16	38	23	14	9	0.12
902033	PC00103	M8	150	25	19	56	27	17	9	0.25
902034	PC00201	M10	60	25	12	19	22	11	11	0.06
902037	PC00202	M10	100	25	16	38	25	14	11	0.12
902040	PC00203	M10	150	25	19	56	28	17	11	0.25
902041	PC00301	M12	60	25	12	18	23	11	13	0.08
902048	PC00302	M12	100	32	19	32	28	17	13	0.16
902060	PC00303	M12	150	32	22	51	33	19	13	0.29
902392	PC00401	M16	60	32	16	10	25	14	18	0.08
902393	PC00402	M16	100	38	19	31	31	17	18	0.19
902394	PC00403	M16	150	38	22	48	33	19	18	0.36
902395	PC00501	M20	100	38	19	27	31	17	22	0.18
902396	PC00502	M20	150	38	25	48	38	22	22	0.37
902397	PC00503	M20	200	50	30	56	41	25	22	0.73
902398	PC00601	M22	150	50	32	42	44	27	24	0.63
902462	PC00602	M22	200	50	32	48	47	30	24	1.00
902475	PC00603	M22	250	50	38	77	52	33	24	1.34
902523	PC00701	M24	150	50	32	42	46	27	26	0.58
902540	PC00702	M24	200	50	32	48	49	30	26	0.95
902541	PC00703	M24	250	50	38	77	52	33	26	1.28

Usage Examples

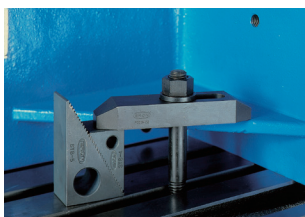
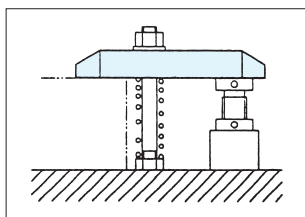
Jig Set-up Systems
(Q-lock)

Base Elements

Clamp Units

Clamping Parts

Mechanical Parts

Machine Vises

Surface Plates and
Measurement Instruments

Index