

RoHS Compliant

ERON®

No.E-9400

# Stud Bolts

Material S45C Heat Treatment HRC30 ± 5 heat treatment

Surface Treatment Blackened

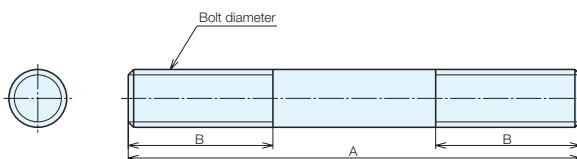

## Specifications

Order No.	No.	Screw Diameter (Coarse Thread)	A	B	Weight (g)		
901117	BM00850	M8×1.25	50	22	20		
902711	BM00875	M8×1.25	75	30	30		
902712	BM08100	M8×1.25	100	40	40		
900036	BM08125	M8×1.25	125	40	50		
902713	BM08150	M8×1.25	150	40	60		
902714	BM08175	M8×1.25	175	40	70		
902715	BM08200	M8×1.25	200	40	80		
902716	BM01050	M10×1.5	50	22	31		
902717	BM01075	M10×1.5	75	30	47		
902718	BM10100	M10×1.5	100	40	63		
902719	BM10125	M10×1.5	125	40	78		
902720	BM10150	M10×1.5	150	40	94		
902721	BM10175	M10×1.5	175	40	109		
902722	BM10200	M10×1.5	200	40	125		
902723	BM01250	M12×1.75	50	22	35		
902724	BM01275	M12×1.75	75	30	55		
902725	BM12100	M12×1.75	100	40	70		
902726	BM12125	M12×1.75	125	40	95		
902727	BM12150	M12×1.75	150	40	115		
902728	BM12175	M12×1.75	175	40	140		
902729	BM12200	M12×1.75	200	40	160		
916420	BM12225	M12×1.75	225	60	180		
916421	BM12250	M12×1.75	250	60	200		
916422	BM12300	M12×1.75	300	60	240		
916423	BM12350	M12×1.75	350	60	285		
916424	BM12400	M12×1.75	400	60	330		
916425	BM12450	M12×1.75	450	60	375		
916426	BM12500	M12×1.75	500	60	420		
902730	BM01450	M14×2	50	22	61		
902731	BM01475	M14×2	75	30	92		
902732	BM14100	M14×2	100	40	123		
902733	BM14125	M14×2	125	40	153		
900120	BM14150	M14×2	150	40	184		
902734	BM14175	M14×2	175	40	215		
902735	BM14200	M14×2	200	40	246		
902736	BM14225	M14×2	225	60	276		
902737	BM14250	M14×2	250	60	367		
902738	BM14300	M14×2	300	60	369		
902739	BM14350	M14×2	350	60	430		
902740	BM14400	M14×2	400	60	492		
902741	BM01675	M16×2	75	30	120		
902742	BM16100	M16×2	100	40	160		
902743	BM16125	M16×2	125	40	200		
902744	BM16150	M16×2	150	40	241		
902745	BM16175	M16×2	175	40	281		
902746	BM16200	M16×2	200	40	321		
902747	BM16225	M16×2	225	60	361		
902748	BM16250	M16×2	250	60	401		

Jig Set-up Systems  
(Q-lock)

Base Elements

Clamp Units

Clamping Parts

Mechanical Parts

Machine Vises

Surface Plates and  
Measurement Instruments

Index

## Specifications

Order No.	No.	Screw Diameter (Coarse Thread)	A	B	Weight (g)		
902749	BM16300	M16×2	300	60	482		
902750	BM16350	M16×2	350	60	562		
902751	BM16400	M16×2	400	60	643		
902752	BM16450	M16×2	450	60	723		
902753	BM16500	M16×2	500	60	803		
902754	BM01875	M18×2.5	75	30	152		
902755	BM18100	M18×2.5	100	40	203		
902756	BM18125	M18×2.5	125	40	254		
902757	BM18150	M18×2.5	150	40	305		
902758	BM18175	M18×2.5	175	40	356		
902759	BM18200	M18×2.5	200	40	406		
902760	BM18225	M18×2.5	225	60	457		
902761	BM18250	M18×2.5	250	60	508		
902762	BM18300	M18×2.5	300	60	610		
902763	BM18350	M18×2.5	350	60	712		
902764	BM18400	M18×2.5	400	60	813		
902765	BM18450	M18×2.5	450	60	915		
902766	BM18500	M18×2.5	500	60	1017		
902767	BM02075	M20×2.5	75	30	188		
902768	BM20100	M20×2.5	100	40	251		
902769	BM20125	M20×2.5	125	40	314		
902770	BM20150	M20×2.5	150	40	376		
902771	BM20175	M20×2.5	175	40	439		
902772	BM20200	M20×2.5	200	40	502		
902773	BM20225	M20×2.5	225	60	565		
902774	BM20250	M20×2.5	250	60	628		
902775	BM20300	M20×2.5	300	60	753		
902776	BM20350	M20×2.5	350	60	879		
902777	BM20400	M20×2.5	400	60	1004		
902778	BM20450	M20×2.5	450	60	1130		
902779	BM20500	M20×2.5	500	60	1256		
902780	BM02275	M22×2.5	75	30	227		
902781	BM22100	M22×2.5	100	40	303		
902782	BM22125	M22×2.5	125	40	379		
902783	BM22150	M22×2.5	150	40	455		
902784	BM22175	M22×2.5	175	40	531		
902785	BM22200	M22×2.5	200	40	607		
902786	BM22250	M22×2.5	250	60	759		
902787	BM22300	M22×2.5	300	60	911		
902788	BM22350	M22×2.5	350	60	1063		
902789	BM22400	M22×2.5	400	60	1215		
902790	BM22450	M22×2.5	450	60	1367		
902791	BM22500	M22×2.5	500	60	1519		
902792	BM02475	M24×3	75	30	271		
902793	BM24100	M24×3	100	40	361		
902794	BM24125	M24×3	125	40	452		
902795	BM24150	M24×3	150	40	542		
902796	BM24175	M24×3	175	40	633		
902797	BM24200	M24×3	200	40	723		
902798	BM24250	M24×3	250	60	904		
902799	BM24300	M24×3	300	60	1085		
902800	BM24350	M24×3	350	60	1266		
902801	BM24400	M24×3	400	60	1446		
900111	BM24450	M24×3	450	60	1627		
902802	BM24500	M24×3	500	60	1808		
995949	BM30200	M30×3.5	200	50	1100		
995950	BM30250	M30×3.5	250	50	1380		
995951	BM30300	M30×3.5	300	50	1650		
995952	BM30350	M30×3.5	350	50	1930		
995953	BM30400	M30×3.5	400	50	2200		
995954	BM30450	M30×3.5	450	50	2480		

## ■ Specifications

Order No.	No.	Screw Diameter (Coarse Thread)	A	B	Weight (g)		
995955	BM30500	M30×3.5	500	50	2760		
995956	BM30550	M30×3.5	550	50	3030		
995957	BM30600	M30×3.5	600	50	3310		
995958	BM30650	M30×3.5	650	50	3580		
995959	BM30700	M30×3.5	700	50	3860		
995960	BM30750	M30×3.5	750	50	4130		
995961	BM30800	M30×3.5	800	50	4410		
995962	BM30850	M30×3.5	850	50	4680		
995963	BM30900	M30×3.5	900	50	4960		
995964	BM30950	M30×3.5	950	50	5240		
995965	BM301000	M30×3.5	1000	50	5510		

Jig Set-up Systems  
(Q-lock)

Base Elements

Clamp Units

Clamping Parts

Mechanical Parts

Machine Vises

Surface Plates and  
Measurement Instruments

Index