

RoHS Compliant



No.E-9390

4-claw Clamp

Material Main body: FCD500 Jaw: SCM420 Base: S45C

Heat Treatment Main body: Annealing Jaw: HRC57 heat treatment

Surface Treatment Main body: Painting

● Maximum clamping force is 40kN (tightening torque: 190N·m)

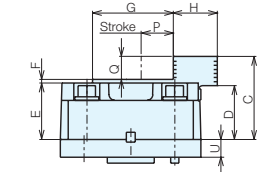
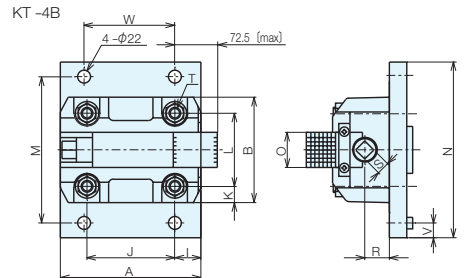
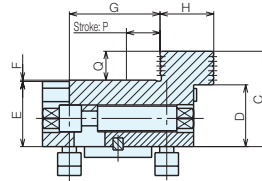
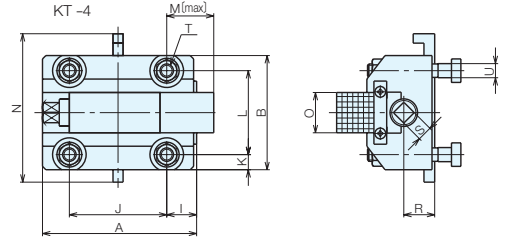

Accessories

KT-4



- Retreat prevention key : 1 piece
- Key check plate : 1 piece
- T-slot bolts : 4 pieces
- Flanged nuts : 4 pieces

KT-4B

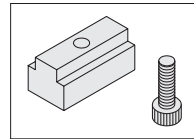

Guide block: 1 piece
Compatible T-slot width is one of 22, 24 or 28 mm.
Choose the compatible one.

Usage Examples

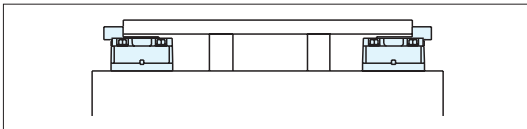
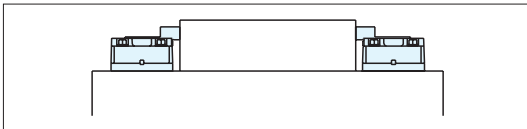

Specifications and Prices

Order No.	No.	Model	Compatible T-slot Width	A	B	C	D	E	F	G	H	I	J	K
945463	KT4	Vertical lathe	22	240	180	142	92	97	2	138	80	45	150	27.5
951904	KT4B	Double column machine	22, 24, 28	240	180	142	92	97	2	138	80	45	150	27.5

No.	L	M	N	O	P	Q	R	S	T (Coarse Thread)	U	V	W	Weight (kg)	Clamping Force (kN)
KT4	125	72.5	225	60	55	43	42	22	M20 × 2.5	21.6	-	-	29	40
KT4B	125	250	300	60	55	43	42	22	M20 × 2.5	30	25	160	45	40

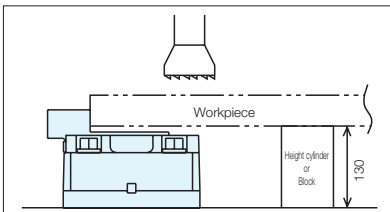

- Workpieces must not directly contact with the top surface of the Jaw.
- Use a height cylinder, block, or the like to raise the workpiece.
- When you cannot secure the 4-jaw clamp onto the machine table, substitute with a plane clamp or the like.