



RoHS Compliant

(Japan, Switzerland, Taiwan) No. E-9775Q

# Lock-tight FA Quick One Machine Vises

- Accessories**
- Standard clamping set (2 pieces per set) compatible T-slot width 18 mm ... 2 sets
  - Standard guide block (2 pieces per set) compatible groove width 18 mm ... 1 set
  - Handle ... 1 piece, eyebolt for lifting up ... 1 set

- Can be clamped easily and speedily with just one rotation using the newly developed mechanical pressure mechanism.
- The clamping force can be easily set simply by rotating the adjustment knob by hand.
- The mechanism is designed such that once the clamping force has been set, the vise will only operate at same clamping force, offering stable repeatable operations.
- Because of the mechanical pressure mechanism, the effect of temperature variations on the clamping force is small, and there is no need to replace consumables such as seals.
- The sliding jaw and workpiece are prevented from lifting up by an anti-floating mechanism.
- The main body is made of ductile cast iron, preventing bending and breakage during tightening.
- Sliding surfaces have been flame heat treated (HRC45) and offer excellent wear resistance.
- High accuracy that surpasses the former JIS standards 0 grade.
- Parallel accuracy of matched specification products is within 0.01.
- If the handle has interference with the machine table, use the handle joint (sold separately).
- The LTFH type can be used in all kinds of situations by attaching to an angle plate or mounting vertically for horizontal machining centers

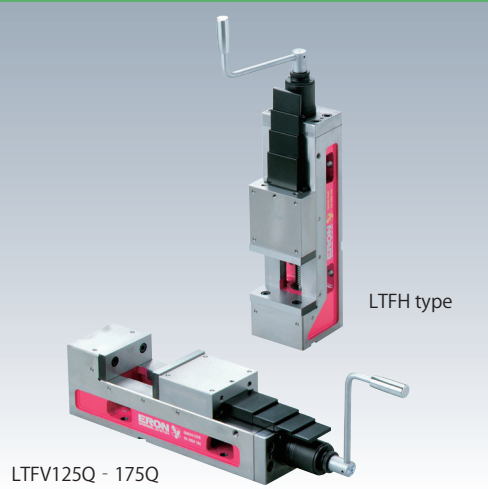

LTFV125Q - 175Q

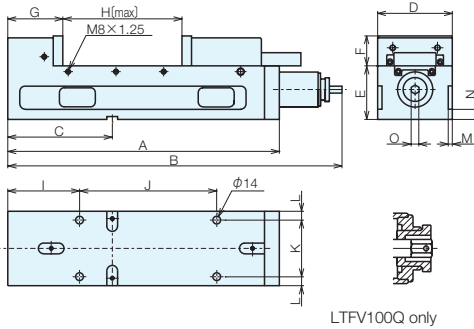

LTFV100Q only

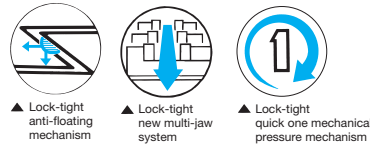

## Size Chart

No.	A	B	C	D	E	F	G	H	I	J	K	L	M	N	O
LTFV100Q	393	483.5	150	102	90	43	92	140	120	180	75	14.5	6.5	17	13
LTFV,LTFH125Q	455	560	175	125	90	50	92	200	120	230	95	16	7	17	13
LTFV,LTFH150Q	568	700	175	150	100	60	112	260	134	315	122	15	7	20	13
LTFV,LTFH175Q	609	741	175	175	115	70	115	280	140	350	145	16	7	20	13

## LTFV Type Specifications

No.	Jaw Width	Jaw Depth	Jaw Opening	Standard Guide Block Width	Clamping force kN	Weight (kg)	LTFV-Q		LTFV-QG (Matched Specification)	
							Order No.	No.	Order No.	No.
LTFV100Q	102	45	140	18	25	25.5	962282	LTFV100Q	962283	LTFV100QG
LTFV125Q	125	50	200	18	30	35	952058	LTFV125Q	952064	LTFV125QG
LTFV150Q	150	60	260	18	40	58	952059	LTFV150Q	952065	LTFV150QG
LTFV175Q	175	70	280	18	40	79	952060	LTFV175Q	952066	LTFV175QG

## LTFH Type Specifications

No.	Jaw Width	Jaw Depth	Jaw Opening	Standard Guide Block Width	Clamping force kN	Weight (kg)	LTFH-Q		LTFH-QG (Matched Specification)	
							Order No.	No.	Order No.	No.
LTFH125Q	123	50	200	18	30	35	952061	LTFH125Q	952067	LTFH125QG
LTFH150Q	150	60	260	18	40	58	952062	LTFH150Q	952068	LTFH150QG
LTFH175Q	175	70	280	18	40	79	952063	LTFH175Q	952069	LTFH175QG



## Handle Joint - Specifications

Order No.	No.	Effective Length
962533	LTQ- 80HJ	80
962534	LTQ-200HJ	200

## Accessories and Optional Parts (Refer to the Following Page)Reference Pages



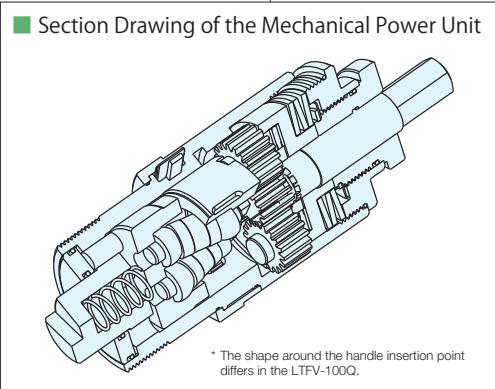
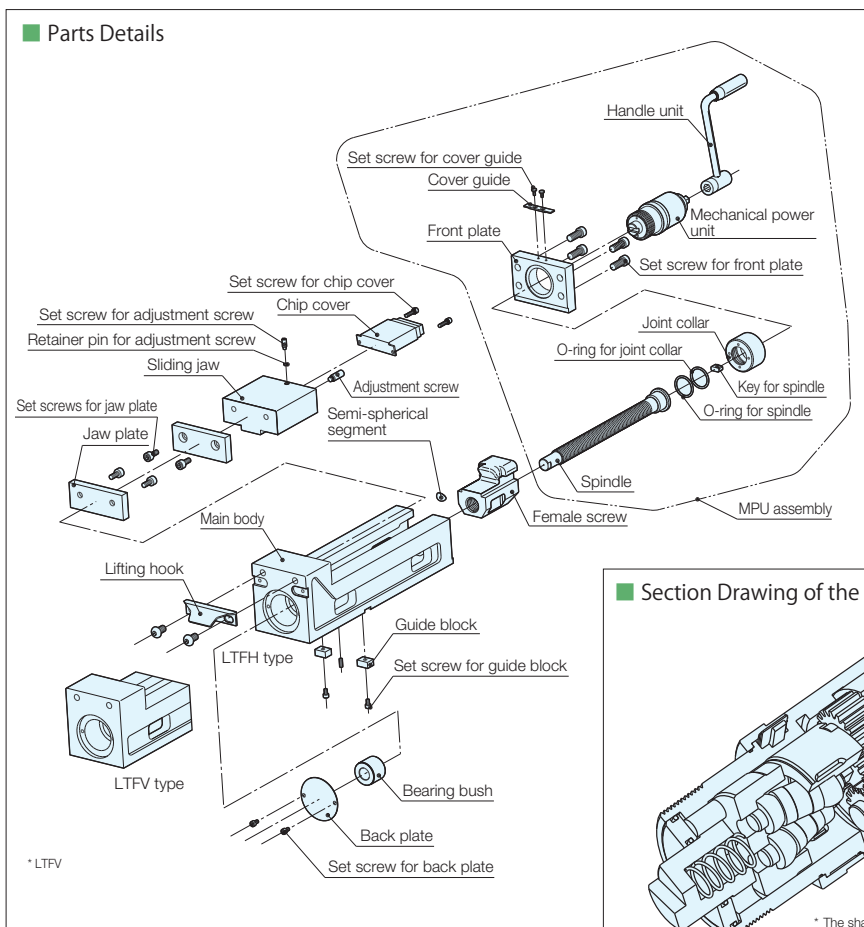

When ordering parallel products (A and B align within 0.01 no matter how many pieces)  
 If the suffix of the manufacture no. (attached to the outer box and main body) is the same letter, then the products are parallel no matter how many pieces (for standard guide blocks). There is no charge for parallel products.

- When purchasing for the first time  
 Order matched specification products (suffix G).  
 When ordering, specify the groove width of the machine you are using.
- For additional orders  
 Contact us with the suffix letter of the manufacture no. of a vise that you have (stamped on the name plate).

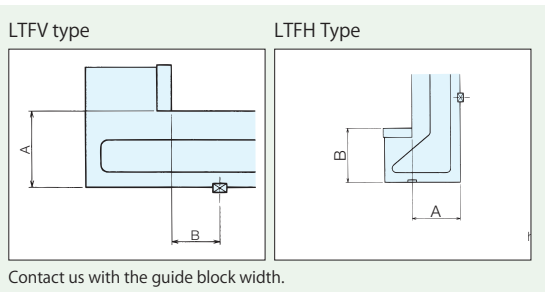

### Accuracy Standards (Static Accuracy)

No.	Inspection Points (per 100 mm)	Former JIS Standard (O Grade)	Nabeya SPEC
1	Parallelism between bottom surface of main body and sliding jaw	0.015	0.010
2	Perpendicularity between jaw plate and sliding jaw	0.030	0.015
3	Perpendicularity between T-slot and jaw plate surface of stationary jaw side.	0.015	0.015
4	Parallelism between T-slot and jaw plate surface of stationary jaw side. Applies to LTFV type. Applies to LTFH type.	0.015	0.015
5	Parallelism between the bottom surface of the main body and the jaw plate surface of stationary jaw side.	-	0.015
6	Parallelism between top surface of clamped test block and bottom surface of main body	0.020	0.015
7	Lift-up of top surface of clamped test block	0.030	0.015

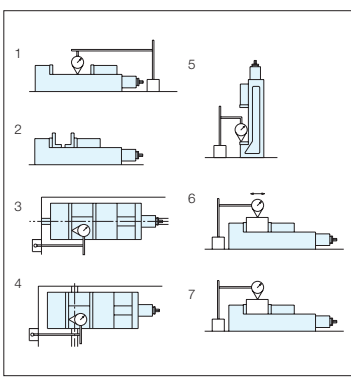

- Jig Set-up Systems (Q-lock)
- Base Elements
- Clamp Units
- Clamping Parts
- Mechanical Parts
- Machine Vises
- Surface Plates and Measurement Instruments
- Index