

RoHS Compliant

ERON®

No.E-9471

# Pla Double Flanged Nuts

**Material** Engineering plastic (PBT resin)

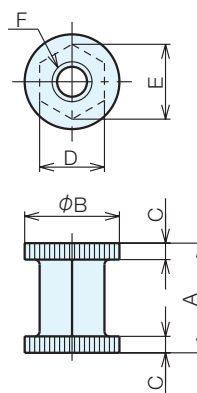

## Specifications

Order No.	No.	A	B	C	D	E	F	Weight (g)
929996	PNM08	22	19	3.3	13	15	M8	5

RoHS Compliant

ERON®

No.E-9470

# Aluminum Stud Bolts

**Material** A5056-H34 **Surface Treatment** Alumite treatment

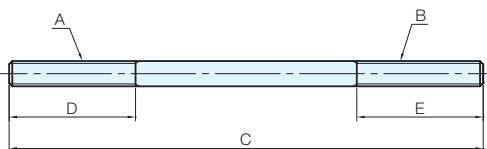

## Specifications

Order No.	No.	A	B	C	D	E	Weight (g)
935724	ABM0806-100	M8	M 6	100	40	10	13
935725	ABM0806-125	M8	M 6	125	40	10	16
935726	ABM0806-150	M8	M 6	150	40	10	20
935727	ABM0806-175	M8	M 6	175	40	10	23
935728	ABM0806-200	M8	M 6	200	40	10	27
929991	ABM08-100	M8	M 8	100	40	40	14
929992	ABM08-125	M8	M 8	125	40	40	17
929993	ABM08-150	M8	M 8	150	40	40	20
929994	ABM08-175	M8	M 8	175	40	40	24
929995	ABM08-200	M8	M 8	200	40	40	27
934610	ABM0810-100	M8	M10	100	40	20	15
934611	ABM0810-125	M8	M10	125	40	20	18
934612	ABM0810-150	M8	M10	150	40	20	22
934613	ABM0810-175	M8	M10	175	40	20	25
934614	ABM0810-200	M8	M10	200	40	20	29
934615	ABM0812-100	M8	M12	100	40	25	18
934616	ABM0812-125	M8	M12	125	40	25	21
934617	ABM0812-150	M8	M12	150	40	25	25
934618	ABM0812-175	M8	M12	175	40	25	28
934619	ABM0812-200	M8	M12	200	40	25	32

Jig Set-up Systems  
(Q-lock)

Base Elements

Clamp Units

Clamping Parts

Mechanical Parts

Machine Vises

Surface Plates and  
Measurement Instruments

Index